

# **milsons®**

Delivering New Zealand's  
Leading Fastening Experience

**Effortless Drilling  
into Hard Materials**



**410 Stainless Steel  
Self-Drilling Screws (SDS)**



# 410 Stainless Steel Self-Drilling Screws (SDS)

Wing Tek Point  
Phillips Drive

Countersunk Head  
Square Drive

Hex Washer  
Face

Pan Head  
Square Drive

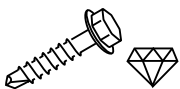

## Superior Hardness & Strength

Manufactured from martensitic 410 stainless steel, these screws deliver exceptional tensile and yield strength, offering enhanced wear resistance and durability in demanding environments.



## Enhanced Heat Resistance

With the ability to maintain mechanical integrity at moderately elevated temperatures, 410 stainless steel SDS screws perform reliably in applications exposed to heat.



## Reliable Corrosion Resistance

While not as corrosion-resistant as austenitic stainless steels (e.g., 304 or 316), 410 stainless steel provides solid protection against normal atmospheric conditions and mildly corrosive environments, making it a suitable choice for various structural and industrial applications.

## Effortless Drilling into Hard Materials

Engineered for durability and performance, 410 stainless steel self-drilling screws (SDS) provide a reliable fastening solution for applications requiring high strength, hardness, and moderate corrosion resistance. Ideal for drilling into harder metals, these screws streamline installation (no need for pre-drilling) while ensuring long-lasting performance.

## Optimised Self-Drilling Performance

The high hardness of 410 stainless steel ensures efficient drilling into tougher metals without excessive wear or premature failure, improving productivity and reducing installation time.

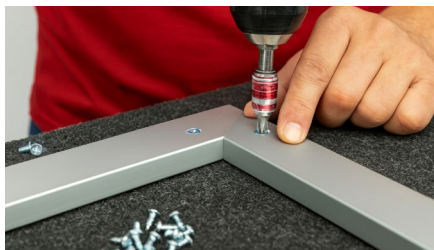

## Ideal Applications

- + Metal-to-metal fastening in structural and industrial settings
- + Mildly corrosive environments where enhanced strength is required
- + Heat-exposed applications demanding long-term performance
- + Construction, manufacturing, and engineering projects requiring self-drilling capability

Choose 410 Stainless Steel SDS Screws for superior strength, durability, and efficiency in demanding applications.

## Retail & User-Friendly Packaging

Our commitment to convenience and sustainability extends to our packaging solutions.

- + Eco-Friendly Materials – Made from recycled materials, our packaging reduces environmental impact.
- + Clear Window Boxes – Customers can easily identify the product without opening the packaging.
- + Intuitive Labeling – Designed with color coding, font size variations, and structured layouts for easy selection and product recognition.

## Self Drilling Screws

### Countersunk - Square

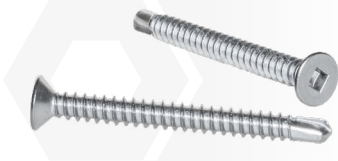

Inventory ID	Gauge	TPI	Length, mm	Thread Length, mm	Drilling Capacity, mm	Driver Bit Size, inch / mm
SDFHSQ4108X25-B100	8	18	25	20	2.5mm	#2 SQ / 3.0
SDFHSQ4108X32-B100	8	18	32	27	2.5mm	#2 SQ / 3.0
SDFHSQ4108X40-B100	8	18	40	35	2.5mm	#2 SQ / 3.0
SDFHSQ41010X20-B100	10	16	20	15	2.5mm	#2 SQ / 3.0
SDFHSQ41010X25-B100	10	16	25	20	2.5mm	#2 SQ / 3.0
SDFHSQ41010X32-B100	10	16	32	27	2.5mm	#2 SQ / 3.0
SDFHSQ41010X40-B100	10	16	40	35	2.5mm	#2 SQ / 3.0
SDFHSQ41010X50-B100	10	16	50	45	2.5mm	#2 SQ / 3.0

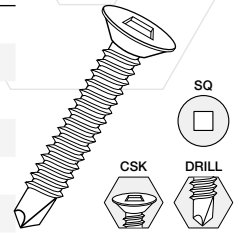

## Self Drilling Screws

### Pan - Square



Inventory ID	Gauge	TPI	Length, mm	Thread Length, mm	Drilling Capacity, mm	Driver Bit Size, inch / mm
SDPSQ4108X20-B100	8	18	20	15	2.5mm	#2 SQ / 3.0
SDPSQ4108X25-B100	8	18	25	20	2.5mm	#2 SQ / 3.0
SDPSQ4108X32-B100	8	18	32	27	2.5mm	#2 SQ / 3.0
SDPSQ4108X40-B100	8	18	40	35	2.5mm	#2 SQ / 3.0
SDPSQ41010X16-B100	10	16	16	11	3.5mm	#2 SQ / 3.0
SDPSQ41010X20-B100	10	16	20	15	3.5mm	#2 SQ / 3.0
SDPSQ41010X25-B100	10	16	25	20	3.5mm	#2 SQ / 3.0
SDPSQ41010X32-B100	10	16	32	27	3.5mm	#2 SQ / 3.0
SDPSQ41010X40-B100	10	16	40	35	3.5mm	#2 SQ / 3.0
SDPSQ41010X50-B100	10	16	50	45	3.5mm	#2 SQ / 3.0

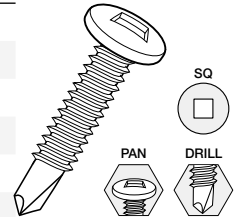

## Self Drilling Screws

### Wing Tek - Phillips



Inventory ID	Gauge	TPI	Length, mm	Thread Length, mm	Drilling Capacity, mm	Driver Bit Size, inch / mm
SDFHPSSEW10X40SS-B100	10	16	40	35	3.5mm	#2 PH / 5.5
SDFHPSSEW10X60SS-B100	10	16	60	35	3.5mm	#2 PH / 5.5
SDFHPSSEW10X75SS-B100	10	16	75	35	3.5mm	#2 PH / 5.5

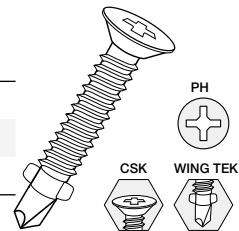

## Hex Washer Face Screws

### Self Drilling Steel



Inventory ID	Gauge	TPI	Length, mm	Thread Length, mm	Drilling Capacity, mm	Driver Bit Size, inch / mm
SDHWF41012X20-B100	12	14	20	15	4.5mm	5/16" HEX / 7.9
SDHWF41012X25-B100	12	14	25	20	4.5mm	5/16" HEX / 7.9
SDHWF41012X35-B100	12	14	35	27	4.5mm	5/16" HEX / 7.9
SDHWF41012X38-B100	12	14	38	27	4.5mm	5/16" HEX / 7.9
SDHWF41012X45-B100	12	14	45	27	4.5mm	5/16" HEX / 7.9
SDHWF41012X50-B100	12	14	50	27	4.5mm	5/16" HEX / 7.9
SDHWF41012X65-B100	12	14	65	27	4.5mm	5/16" HEX / 7.9
SDHWF41012X75-B100	12	14	75	27	4.5mm	5/16" HEX / 7.9
SDHWF41014X25-B100	14	14	25	20	5.0mm	3/8" HEX / 9.5
SDHWF41014X32-B100	14	14	32	27	5.0mm	3/8" HEX / 9.5
SDHWF41014X38-B100	14	14	38	27	5.0mm	3/8" HEX / 9.5
SDHWF41014X45-B100	14	14	45	27	5.0mm	3/8" HEX / 9.5
SDHWF41014X50-B100	14	14	50	27	5.0mm	3/8" HEX / 9.5
SDHWF41014X65-B100	14	14	65	27	5.0mm	3/8" HEX / 9.5
SDHWF41014X75-B100	14	14	75	27	5.0mm	3/8" HEX / 9.5
SDHWF41014X90-B100	14	14	90	27	5.0mm	3/8" HEX / 9.5
SDHWF41014X125-B100	14	14	125	27	5.0mm	3/8" HEX / 9.5

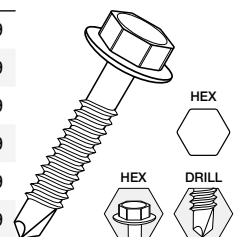

The data provided in this document is for general guidance only and should not be solely relied upon when working to stringent specifications. We recommend consulting with qualified experts regarding any technical queries. This information may change without written notice.





# **milsons®**

Delivering New Zealand's  
Leading Fastening Experience

## Head Office:

📍 20 Kaimanawa Street,  
PO Box 672  
Palmerston North, 4444

✉ Email us  
[info@milsons.co.nz](mailto:info@milsons.co.nz)

☎ Call us on  
**0800 507 444**

🌐 Visit our website  
[milsons.co.nz](http://milsons.co.nz)

## Branches:

### Auckland

📍 71C Patiki Road,  
Avondale, Auckland, 1026

☎ Call us on  
**09 280 4609**

### Hamilton

📍 740 Arthur Porter Drive,  
Te Rapa, Hamilton, 3200

☎ Call us on  
**07 282 0490**

### Wellington

📍 126 Nelson Street,  
Petone, Lower Hutt, 5012

☎ Call us on  
**04 282 1298**

